

# Dedicated Screwdrivers for DLR5040A-WE and DLR5340-WE Non-CE

Small



Big

## Specifications

|                          |                      | Miniature Screw (1.0 - 3.5 mm) |                         |                         |                         |                         |                         |
|--------------------------|----------------------|--------------------------------|-------------------------|-------------------------|-------------------------|-------------------------|-------------------------|
| Model                    | Lever Start          | DLV7020-SPC                    | DLV7030-SPC             | DLV7031-SPC             | -                       | -                       | -                       |
|                          | Push to Start        | -                              | -                       | -                       | DLV8020-SPC             | DLV8030-SPC             | DLV8031-SPC             |
| <b>Input Voltage</b>     |                      | 100 V AC, 50/60 Hz             |                         |                         |                         |                         |                         |
| <b>Torque Adjustment</b> |                      | Stepless                       |                         |                         |                         |                         |                         |
| <b>Torque</b>            | (Nm [lbf-in])        | 0.05 - 0.55 [0.4 - 4.9]        | 0.30 - 1.10 [2.7 - 9.7] | 0.30 - 1.00 [2.7 - 8.9] | 0.10 - 0.55 [0.9 - 4.9] | 0.30 - 1.10 [2.7 - 9.7] | 0.30 - 1.00 [2.7 - 0.9] |
| <b>Free Speed</b>        | (min <sup>-1</sup> ) | 900                            | 650                     | 1200                    | 900                     | 650                     | 1200                    |
| <b>Power Consumption</b> |                      | Approx. 25                     |                         |                         |                         |                         |                         |
| <b>Screw Size</b>        | Machine Screw        | 1.0 - 3.0                      | 2.0 - 3.5               | 2.0 - 3.0               | 1.0 - 3.0               | 2.0 - 3.5               | 2.0 - 3.0               |
|                          | Tapping Screw        | 1.2 - 2.6                      | 2.0 - 3.0               |                         | 1.2 - 2.6               | 2.0 - 3.0               |                         |
| <b>Bit Type</b>          |                      | A                              |                         |                         |                         |                         |                         |
| <b>Mass</b>              | (g [lbs])            | 380 [0.84]                     |                         |                         | 390 [0.86]              |                         |                         |
| <b>Cord Length</b>       |                      | 3 (with connector)             |                         |                         |                         |                         |                         |
| <b>Bit Grounding</b>     |                      | Equipped as standard           |                         |                         |                         |                         |                         |

|                          |                      | Machine Screw(2.6 - 8.0 mm)                       |                          |                           |   |                           |             |
|--------------------------|----------------------|---|--------------------------|---------------------------|---|---------------------------|-------------|
| Model                    | Lever Start          | DLV7120-SPC                                       | DLV7130-SPC              | DLV7140-SPC               | DLV7231-SPC                                       | DLV7241-SPC               | DLV7241-SPC |
|                          | Push to Start        | DLV8120-SPC                                       | DLV8130-SPC              | DLV8140-SPC               | DLV8231-SPC                                       | DLV8241-SPC               | DLV8241-SPC |
| <b>Input Voltage</b>     |                      | 100 V AC, 50/60 Hz *1                             |                          |                           |   |                           |             |
| <b>Torque Adjustment</b> |                      | Stepless  |                          |                           |   |                           |             |
| <b>Torque</b>            | (Nm [lbf-in])        | 0.35 - 0.70 [3.10 - 6.20]                         | 0.50 - 1.70 [4.4 - 15.1] | 1.20 - 3.00 [10.6 - 26.6] | 0.50 - 1.70 [4.4 - 15.1]                          | 1.20 - 3.00 [10.6 - 26.6] |             |
| <b>Free Speed</b>        | (min <sup>-1</sup> ) | 1000  |                          | 700                       | 2000  | 1200                      |             |
| <b>Power Consumption</b> |                      | 35  |                          |                           | 45  |                           |             |
| <b>Screw Size</b>        | Machine Screw        | 2.6 - 3.0   | 2.6 - 4.0                | 3.5 - 5.0                 | 2.6 - 4.0   | 3.5 - 5.0                 |             |
|                          | Tapping Screw        | 2.3 - 3.0   | 2.5 - 3.5                | 3.0 - 4.0                 | 2.5 - 3.5   | 3.0 - 4.0                 |             |
| <b>Bit Type</b>          |                      | B *2  |                          |                           |   |                           |             |
| <b>Mass</b>              | (g [lbs])            | 710 [1.57] (7100series) / 670 [1.48] (8100series) |                          |                           | 710 [1.57] (7200series) / 670 [1.48] (8200series) |                           |             |
| <b>Cord Length</b>       |                      | 3 (with connector)                                |                          |                           |   |                           |             |
| <b>Bit Grounding</b>     |                      | Equipped as standard                              |                          |                           |   |                           |             |

|                          |                      | Machine Screw(2.6 - 8.0 mm) |             |
|--------------------------|----------------------|-----------------------------|-------------|
| Model                    | Lever Start          | -                           | DLV7251-SPC |
|                          | Push to Start        | DLV8150-SPC                 | DLV8251-SPC |
| <b>Input Voltage</b>     |                      | 100 V AC, 50/60 Hz *1       |             |
| <b>Torque Adjustment</b> |                      | Stepless                    |             |
| <b>Torque</b>            | (Nm [lbf-in])        | 2.0 - 4.5 [17.7 - 39.8]     |             |
| <b>Free Speed</b>        | (min <sup>-1</sup> ) | 450                         | 700         |
| <b>Power Consumption</b> |                      | 45                          |             |
| <b>Screw Size</b>        | Machine Screw        | 4.5 - 6.0                   |             |
|                          | Tapping Screw        | 4.0 - 5.0                   |             |
| <b>Bit Type</b>          |                      | C                           |             |
| <b>Mass</b>              | (g [lbs])            | 810 [1.79]                  |             |
| <b>Cord Length</b>       |                      | 3 (with connector)          |             |
| <b>Bit Grounding</b>     |                      | Equipped as standard        |             |

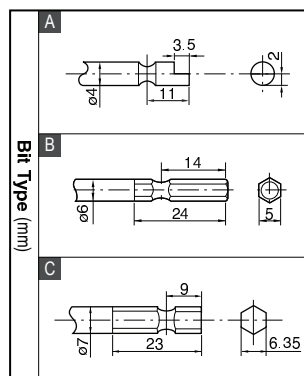

|                          |                      | Machine Screw(2.6 - 8.0 mm)                      |               |               |                             |               |                         |  |
|--------------------------|----------------------|--|---------------|---------------|-----------------------------|---------------|-------------------------|--|
| Model                    | Lever Start          | DLV30A06L-SPC                                    | DLV30A12L-SPC | DLV30A20L-SPC | DLV45A06L-SPC               | DLV45A12L-SPC | DLV70A06L-SPC           |  |
|                          | Push to Start        | DLV30A06P-SPC                                    | DLV30A12P-SPC | DLV30A20P-SPC | DLV45A06P-SPC               | DLV45A12P-SPC | DLV70A06P-SPC           |  |
| <b>Input Voltage</b>     |                      | 100 V AC, 50/60 Hz *1                            |               |               |                             |               |                         |  |
| <b>Torque Adjustment</b> |                      | Stepless   |               |               |                             |               |                         |  |
| <b>Torque</b>            | (Nm [lbf-in])        | 0.4 - 1.6 / 1.2 - 3.0 [3.5 - 14.2 / 10.6 - 26.6] |               |               | 2.0 - 4.5 [17.7 - 39.8]     |               | 3.8 - 7.0 [33.6 - 62.0] |  |
| <b>Free Speed</b>        | (min <sup>-1</sup> ) | 650  | 1200          | 2000          | 650                         | 1200          | 650                     |  |
| <b>Power Consumption</b> |                      | 45   |               |               |                             |               |                         |  |
| <b>Screw Size</b>        | Machine Screw        | 2.6 - 5.0  |               |               | 4.5 - 6.0                   |               | 5.0 - 8.0               |  |
|                          | Tapping Screw        | 2.5 - 4.0  |               |               | 4.0 - 5.0                   |               | 4.5 - 6.0               |  |
| <b>Bit Type</b>          |                      | B *2   |               |               |                             |               |                         |  |
| <b>Mass</b>              | (g [lbs])            | 700 [1.54]                                       |               |               | 870 [1.92] with pistol grip |               |                         |  |
| <b>Cord Length</b>       |                      | 3 (with connector)                               |               |               |                             |               |                         |  |
| <b>Bit Grounding</b>     |                      | Equipped as standard                             |               |               |                             |               |                         |  |

\*1: Please contact us for other voltage availabilities. \*2: Please contact us for 6.35 mm bit type.

## Optional Accessories



**Torque Adjustment Ring Cover**  
DLW5200: DLV7100/7200/8100/8200-SPC  
DLW5300: DLV7000/8000-SPC

- This minimizes tampering or accidental turning of the torque adjustment ring once the torque is set.
- Flanged coupling DLW9011 can not be mounted on SPC type



**Pistol Grip**  
DLW2300: DLV7100/7200/  
8100/8200/30/45/70-SPC

- Suitable for horizontal operation



**TD04061 SPC cord for commercial power source** (optional)

- Dedicated screwdrivers can be directly plugged in commercial power source.