

No. NKH20XL-25/NKH20XR-25

Air-Hydro Heat Nipper (thrust cut type) **NEW**

- Highly durable PTFE Plating blades; melted resin does not adhere to them.
- Improved durability of blades with high-speed chip brazed.
- Easier blade replacement than conventional models; take out the blade unit and exchange with the new one.

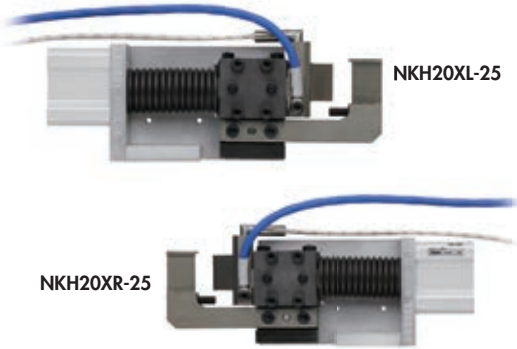

NKH20XL-25

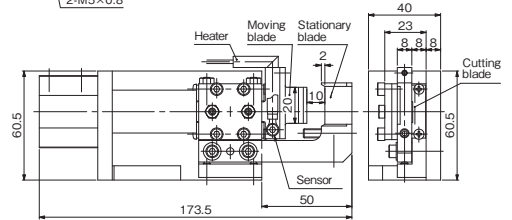
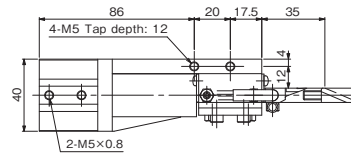

NKH20XR-25

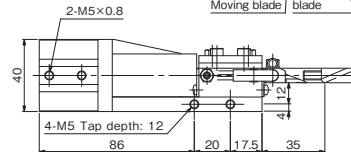
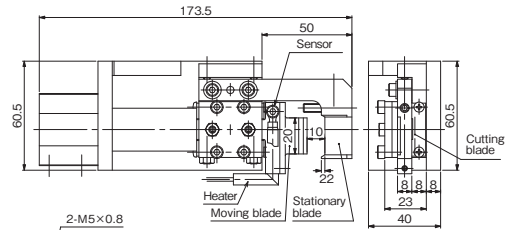

- Requires separately sold Hydro Controller.
- Custom-made blade lengths and cylinder capacities available.

Model No.	Cutting Capacity width x thickness (mm) Acril	Blade Edge Temp. (MAX °C)	Air Consumption (cm ³ /str.)	Piston Stroke (mm)	Weight (g)	EDP No.
NKH20XL-25/ NKH20XR-25	10×1.5	180	60	10	690	—

• Working air hose inner diameter: 4 mm • Air Pressure: 0.6MPa
 ※ The above weight is the product only. The weight of heater and sensor is not included.
 ※ A heater for 200V AC, 220V AC, and 240V AC respectively can be made-to-order.
 ※ The following specifications can be made on request: change in blade length; replacement of cylinder for improvement in performance; additional KINECHEK which does not require a hydro converter (oil).
 • Accessory heater: HTL-28.5-6.25-300L-80W1H (80W/100V AC) Recommended operating temperature 140°C. Cord length 300mm, Weight 13g
 • Accessory temperature sensor: SNO-300L-H(K thermocouple), Recommended operating temperature 140°C. Cord length 300mm, Weight 7g

Blades Specifications

Material	Blade Shape	Blade Opening (mm)	Cutting blade effective (mm)	Weight (g)
Special alloy steel	Knife type (resin)	10	20	125

- Option Parts**
- Hydro-converter (Recommended: KOGANEI AHC 32×50)
Working fluid: Petroleum hydraulic fluid or turbine oil with antifoaming agent additive (VG22~100)
 - Temperature controller (DTC-001)